

#15103 Filed This 5 day of Jan. 1970
 And Recorded in Vol. 4 A Page 45 at 3:38 P.
 Ollie Farnsworth
 Register Mesne Conveyance Greenville County, S. C.

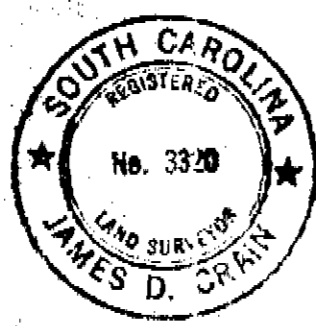
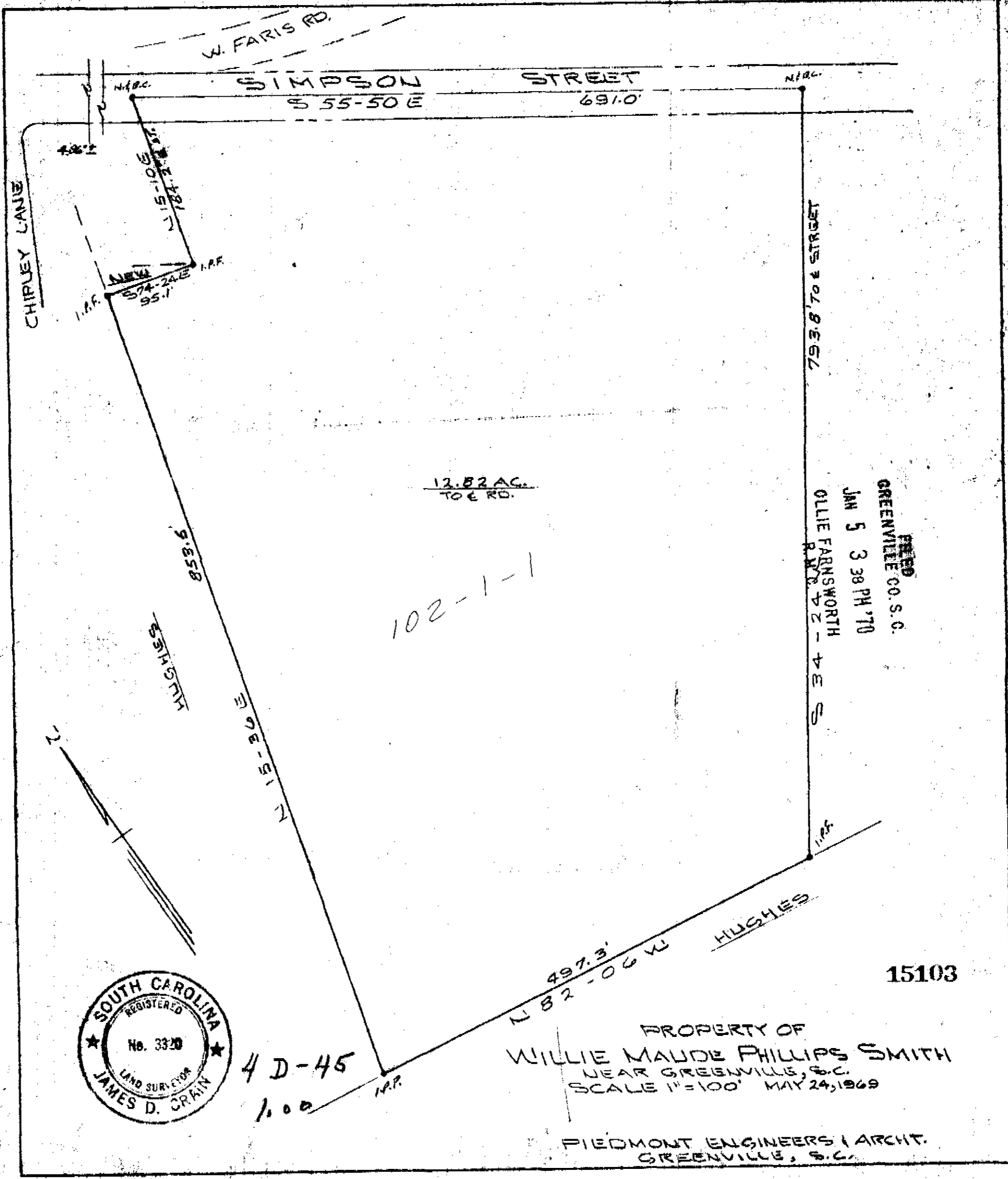

4 D-45
1.00

PROPERTY OF
 WILLIE MAUDE PHILLIPS SMITH
 NEAR GREENVILLE, S.C.
 SCALE 1"=100' MAY 24, 1969

PIEDMONT ENGINEERS (ARCHT.)
 GREENVILLE, S.C.

FILED
 GREENVILLE CO. S. C.
 JAN 5 3 38 PM '70
 OLLIE FARNSWORTH
 R.M. 12-48 S